

Insured: Sally Jane
Home: 87-202 Maia Street
Waianae, HI 96792

Cellular: (808) 668-1790

Claim Rep.: NO INFO

Estimator: Kevin Medeiros
Company: Unlimited Home Services
Business: 590 Farrington Hwy #210
Kapolei, HI 96707

Business: (808) 780-3411
E-mail: uhs808km@gmail.com

Claim Number: 030961542

Policy Number: H32-261-057298-00

Type of Loss: Wind Damage

Date Contacted: 11/12/2014 2:00 PM

Date of Loss: 10/22/2014 2:00 PM

Date Inspected: 11/12/2014 12:00 PM

Date Received: 11/12/2014 2:00 PM

Date Entered: 11/12/2014 5:41 PM

Price List: HIHO8X_NOV14
Restoration/Service/Remodel
Estimate: JANE-SALLY

Unlimited Home Services~License #BC-32154
PMB 129~590 Farrington Hwy #210
Kapolei, HI 96707~(808)-780-3411~uhs808km@gmail.com~

JANE-SALLY

Main Level

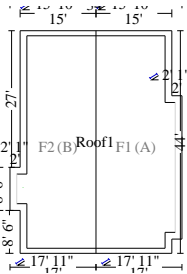

Roof1

1468.51 Surface Area	14.69 Number of Squares
159.65 Total Perimeter Length	44.00 Total Ridge Length

DESCRIPTION	QTY	UNIT PRICE	TAX	O&P	RCV	DEPREC.	ACV
DWELLING							
1. Roofing felt - 30 lb.	14.69	SQ	42.65	46.62	127.42	800.57	(0.00) 800.57
2. R&R Drip edge	159.65	LF	2.75	30.30	88.86	558.20	(0.00) 558.20
*** Drip edge required by Hawaii State Building Code. This is an "add only" item.							
3. Asphalt starter - universal starter course	159.65	LF	2.12	22.72	68.38	429.56	(0.00) 429.56
4. Flashing - pipe jack - lead	3.00	EA	69.97	16.98	42.94	269.83	(0.00) 269.83
5. Remove 3 tab - 25 yr. - comp. shingle roofing - w/out felt	14.69	SQ	70.21	58.32	206.28	1,295.98	(0.00) 1,295.98
6. 3 tab - 25 yr. - comp. shingle roofing - w/out felt	17.00	SQ	227.00	302.35	787.72	4,949.07	(0.00) 4,949.07
***12% waste has been added for a simple roof design and rounded to the nearest bundle.							
7. General Laborer - per hour	20.00	HR	42.99	48.61	171.96	1,080.37	(0.00) 1,080.37
8. R&R Ridge cap - composition shingles	44.00	LF	9.04	24.88	80.02	502.66	(0.00) 502.66
9. Dumpster load - Approx. 20 yards, 4 tons of debris	1.00	EA	551.20	31.16	110.24	692.60	(0.00) 692.60
10. Painting - Labor Minimum	1.00	EA	261.38	14.78	52.28	328.44	(0.00) 328.44
11. R&R Fascia - metal - 6"	15.00	LF	4.83	4.99	14.66	92.10	(0.00) 92.10
12. Drywall - Labor Minimum	1.00	EA	539.19	30.49	107.84	677.52	(0.00) 677.52
13. R&R Ceiling hook	1.00	EA	13.89	0.90	2.80	17.59	(0.00) 17.59
14. R&R 5/8" drywall - hung, taped, with smooth wall finish	64.00	SF	4.73	19.67	61.04	383.43	(0.00) 383.43
*** Family room ceiling about to collapse from water damage							
15. Seal/prime then paint- Kitchen Ceiling (2 coats)	182.15	SF	1.00	11.66	36.70	230.51	(0.00) 230.51
16. Seal/prime then paint- Family Room Ceiling (2 coats)	211.36	SF	1.00	13.53	42.58	267.47	(0.00) 267.47
17. R&R Exhaust cap - through roof - 6" to 8"	1.00	EA	93.22	6.71	18.92	118.85	(0.00) 118.85
Dwelling Totals:			684.67	2020.64	12,694.75		12,694.75
Totals: Roof1			684.67	2,020.64	12,694.75	0.00	12,694.75
Area Dwelling Total:			684.67	2,020.64	12,694.75		12,694.75
Totals: Main Level			684.67	2,020.64	12,694.75	0.00	12,694.75

Labor Minimums Applied

DESCRIPTION	QTY	UNIT PRICE	TAX	O&P	RCV	DEPREC.	ACV	
DWELLING								
18. Finish hardware labor minimum	1.00	EA	165.76	9.37	33.16	208.29	(0.00)	208.29
19. Siding labor minimum	1.00	EA	241.47	13.66	48.30	303.43	(0.00)	303.43
Dwelling Totals:				23.03	81.46	511.72		511.72
Totals: Labor Minimums Applied				23.03	81.46	511.72	0.00	511.72
Area Dwelling Total:				707.70	2,102.10	13,206.47		13,206.47
Line Item Totals: JANE-SALLY				707.70	2,102.10	13,206.47	0.00	13,206.47

Grand Total Areas:

0.00 SF Walls	0.00 SF Ceiling	0.00 SF Walls and Ceiling
0.00 SF Floor	0.00 SY Flooring	0.00 LF Floor Perimeter
0.00 SF Long Wall	0.00 SF Short Wall	0.00 LF Ceil. Perimeter
0.00 Floor Area	0.00 Total Area	0.00 Interior Wall Area
198.48 Exterior Wall Area	0.00 Exterior Perimeter of Walls	
1,468.51 Surface Area	14.69 Number of Squares	319.30 Total Perimeter Length
44.00 Total Ridge Length	0.00 Total Hip Length	

Summary for Dwelling

Line Item Total	10,396.67
Material Excise Tax	113.43
	<hr/>
Subtotal	10,510.10
Overhead	1,051.05
Profit	1,051.05
General Excise Tax	594.27
	<hr/>
Replacement Cost Value	\$13,206.47
Net Claim	\$13,206.47
	<hr/> <hr/>

Kevin Medeiros

Recap of Taxes, Overhead and Profit

	Overhead (10%)	Profit (10%)	Material Excise Tax (4.712%)	General Excise Tax (4.712%)
Line Items	1,051.05	1,051.05	113.43	594.27
Total	1,051.05	1,051.05	113.43	594.27

Recap by Room

Estimate: JANE-SALLY

Area: Main Level

Roof1

9,989.44

96.08%

Area Subtotal: Main Level

9,989.44

96.08%

Labor Minimums Applied

407.23

3.92%

Subtotal of Areas

10,396.67

100.00%

Total

10,396.67

100.00%

Recap by Category

O&P Items	Total	%
GENERAL DEMOLITION	1,811.83	13.72%
DRYWALL	813.75	6.16%
FINISH HARDWARE	177.09	1.34%
LABOR ONLY	859.80	6.51%
PAINTING	654.89	4.96%
ROOFING	5,770.64	43.70%
SIDING	241.47	1.83%
SOFFIT, FASCIA, & GUTTER	67.20	0.51%
O&P Items Subtotal	10,396.67	78.72%
Material Excise Tax	113.43	0.86%
Overhead	1,051.05	7.96%
Profit	1,051.05	7.96%
General Excise Tax	594.27	4.50%
Total	13,206.47	100.00%

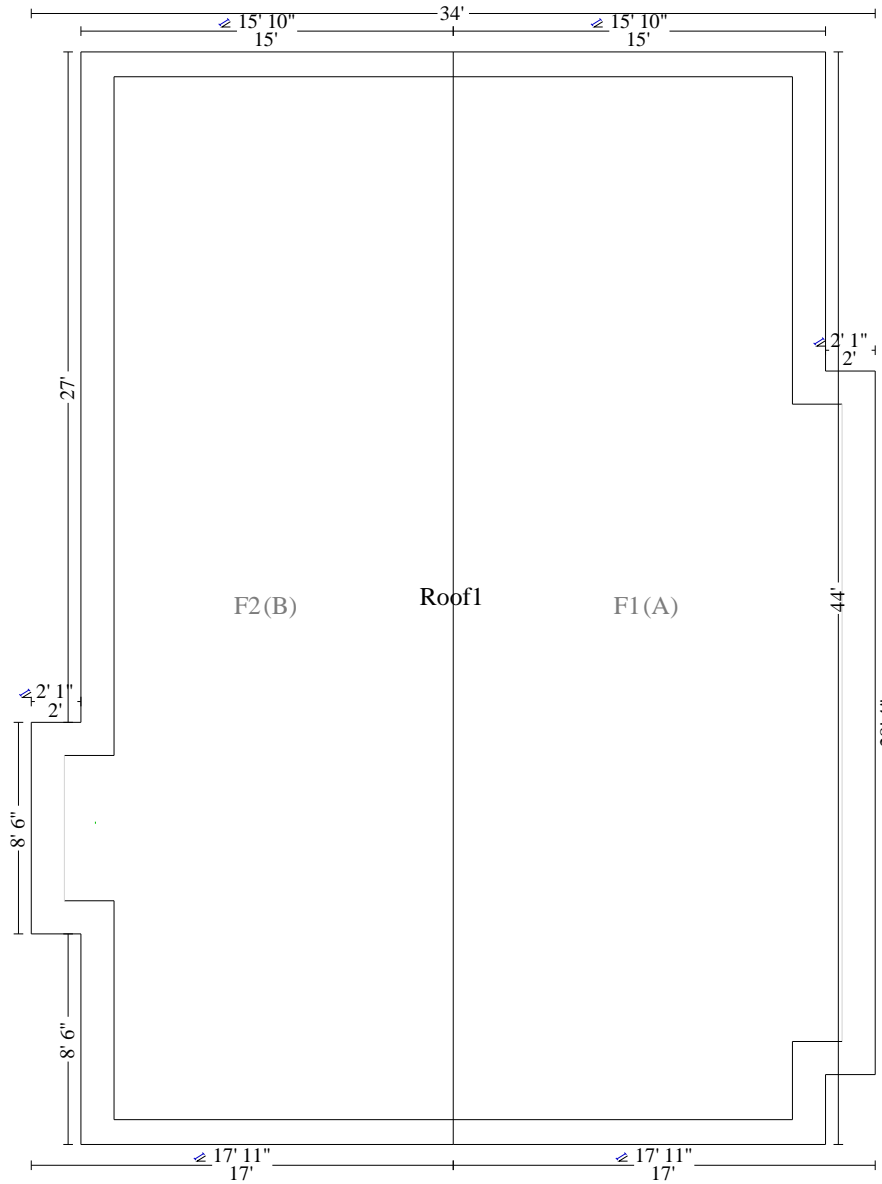

1"



Main Level

Report Index

Coversheet	1
Claim Rep Info	1
Estimator Info	1
Claim Info	1
Dates	1
Price List And Estimate Info	1
Opening Statement	1
Line Item Detail	2
Grand Total Areas	3
Summary	4
Summary Of Add-Ons	5
Recap By Room	6
Recap By Category	7
Sketch	8